

The Gravel Laker

Volume XXIX Number 2

www.gravellake.org

Fall, 2019



In This Issue

- President's Corner
- Is It Time For A Boat Wash?
- GLA Membership Dues Increase
- Summer Event Thanks
- Origins of Huff's Landing
- Meet a Gravel Laker
- Poison Ivy
- Paid Members Listing
- Treasurer's Report
- Paid Members Listing
- Sources
- SIBZ Comic



President's Corner



What a great summer!!

July was steamy, August was moderate, and September (as I write this) is turning out to be one of the best I can remember!

As many of you know, I have a lot of passion for re-establishing natural shorelines around Gravel Lake. I thank my wife, Missy, for lighting the fire and our whole-lake study by Progressive AE for affirming the need for the change. Establishing a natural shoreline can prevent erosion, filter nutrients before they get to the lake, and provide crucial shoreline habitat. While I understand that this is still a new idea for many and could be difficult for some owners to execute, I want to acknowledge the growing efforts I'm seeing around the lake. (Continued on page 2)

President's Corner (continued from page 1)

It goes without saying that the Mastersons on Huff's Landing, and the Andrews on Streeter have fully natural shorelines that represent what the lake looked like before human development. Beyond that, quite a few of you with rip rap (stones) are offsetting that with lake-friendly plantings: Fallon, Carlos, and Rockwell on Chamberlin, Moore and Oltolski on Willow, Bergenham on Winkler, Friend on Lewis, Gordon/Bogner on Streeter, and Fazzini (a particularly good-looking example!) on Gebhard.

I've pushed the DNR to lead by example at the public access: more plants in the rip rap will help runoff from the lot AND stabilize the shoreline to prevent the erosion issues we've had in the past. Additionally, leaving your shoreline with an un-mowed buffer strip is a great, low-maintenance option where you can allow native shoreline plants to reestablish themselves naturally: Gordon on Gebhard, Kurtyak (great example of a deeper buffer AND the use of a variety of native plants; nice martin houses too!) on Gebhard, between Moore's and Osborne's (looks good despite low/no maintenance and serves as valuable runoff filter for the neighborhood) on Willow, Garrison/Mateyack and Kapercev on Idle Ease, North Ct. on Streeter, Zwartz, Beebe/Bainbridge, and Sundar on Chamberlain, Rousell and van Schoyck on Lewis, Deren on Huff's Landing, Davis on Sandy (channelside), LaMonte on Winkler, and Kotal (an EXPANSIVE buffer!) on Winkler.

How about even leaving just a bit of your shoreline natural? McDevitt/Rusthoven on Huff's Landing, McGreal/Morkunas on Sandy, and Meltons on Chamberlin appear to be doing that. In most of the cases there's an opportunity to make your offset or buffer a bit deeper; adding more width between the water and your mowed space will strengthen your shoreline and increase its ability to filter. Finally, most impressive is the lakeside garden that the Howells (Huff's Landing) have established; it's good-looking, has produce (!), and is a very functional buffer and habitat at the lake shore. Great work!

Did I miss your effort? Please let me know about it! Do you have pictures of your progress? Please share them with me and on the Gravel Lake Association Community Facebook group. Do you have questions or need suggestions? I've already had several in-depth discussions with owners who would like to prevent erosion and/or establish a good-looking lakeshore garden.

If you're interested in more objectively evaluating your shoreline, check out the link below. The rating will give you a better idea of what areas you can improve.

<https://www.mishorelandstewards.org/rate.asp>

Craig DeSimone
GLA President





APOLLOMARINE.net



**We rent
Pontoon
Boats!**

**We
service
all lakes!**

**South side of Gravel Lake
15355 96th Avenue, Lawton, Mi 49065**

269-423-611 1-888-996-BOAT

***OPEN 7 DAYS
in Season!***

Is It Time For A Boat Wash?

The state of Michigan is finally starting to catch on. They can see the increasing threat of invasive species to our inland lakes. As of March 21, 2019 it is the law that all boats leaving a lake be cleaned and dried, all drain plugs pulled, and any bait disposed of. Through our special assessment district, Gravel Lakers pay for the removal and control of aquatic invasive species every year. Most of the time we are not the ones bringing them here but we have to manage them or face the consequences. More invasive species enter the state and move from lake to lake all the time, some of them with the potential to cause great harm to our ecosystem and property.

The Gravel Lake Association has started to engage boaters that use the public access, making sure they understand how to stop the spread. Last year we participated in a Landing Blitz movement designed to talk with boaters over the 4th of July holiday season and provide them with an easy way to remember what they need to do; Clean, Drain, Dry. This year, for the second time, we had a mobile boat wash come to our public access. The two staff members from Michigan State University's Mobile Boat Wash Team spoke with all our guest boaters about Clean, Drain, Dry and offered to wash their boats for free after using the lake. They spoke with many people and were able to wash a few boats, but your GLA wants to do even more.

At the Michigan Lakes & Streams conference in May we were able to see a demonstration from a company that makes a boat wash system that doesn't use any water. The system by a company called CD3 (Clean, Drain, Dry, Dispose) uses different brushes, a vacuum, and a tank to collect the plant material from boats. The system reports on how often it's used, if any part of the machine needs maintenance, and if the tank needs to be emptied. In the past we thought



Is It Time For A Boat Wash? (continued from page 4)



a boat wash needed to have water and sewer hook-ups, making it a much more expensive project. With this system, we can provide a way for boaters to Clean, Drain, Dry (are you seeing a pattern here?) helping them comply with the law and reduce the spread of invasive species to our lake and others. We are already paying to maintain the invasive species in our lake. It's time we take it to the next level and contribute to the fight against their spread. We want to do this for the love of our lake and also for the future of all Michigan lakes.

For more information on these topics, please visit the following websites or contact me directly: Melissa DeSimone at madunigan@gmail.com.

Melissa DeSimone





Lawton, Michigan

ALL NATURAL – FREE RANGE FARMING

Proud Sponsor of the Gravel Lake Association...

Black Angus Beef, Pork, Lamb

Reserve Yours Today!

Custom Butchering

Frozen and Vacuum Packaged

Whole/Half/Quarters

Firewood

Seasoned or Fresh Cut

Single Bundles and Bulk

24hr Self-Service

Pick-up or Delivery

Visit our website and learn about our operations and while you are there leave us your email and get on our mailing list...



ShangriLa Farms LLC
31150 96th Ave
Lawton, MI 49065



Tom Zwartz
708/912-0197

www.shangrila-farms.com

Tom Klein
269/587-0175

GLA Membership Dues

At our June membership meeting and picnic, annual membership dues were increased to \$50.00 (from \$35.00) effective January 1, 2020. This vote, motioned and seconded by general members, passed by a wide margin with only two votes against it. The vote followed discussion of the following topics: income vs. expenses, legal defense fund, and a boat wash for the public access.

While the Gravel Lake Association does have what some may consider an ample funds balance, it does obscure the fact that annual expenses far exceed income from membership dues. Newsletter production, the annual picnic, 4th of July activities, and fish stocking are just a few popular items that would not be covered by dues income alone. It is our successful (and labor intensive) fundraising activities that allow us to have a comfortable fund balance and enable us pursue high-dollar efforts like our whole-lake study (~\$20K) with expedience. Though fundraising income may seem sure to some, it is precarious. Some of you may remember the Gravel Lake Socials we used to host that were solid fundraisers for us. Eventually, that event lost popularity and an income source was lost. Currently, our Poker Run is the best fundraiser the GLA has ever done, but it has been at risk of cancellation (due to lack of dock hosts) for the last two years and we can only hope it maintains its popularity. Even our Gravel Lake gear sales are just now profitable (vs. being a "public service" in years past) thanks to the re-doubled efforts of our very passionate fundraising committee (nice work Carlie, Janice, Jen, and Suzanne!).

Regarding legal issues, we've learned from other lake associations via Michigan Lakes & Streams Association that Gravel Lake has simply been lucky not to suffer an external whole-lake threat. Examples include DNR purchase/expansion of public access sites to allow greater lake usage, industrial pig farming very close to a lake (CA-FOS) which poses a pollution threat, and subdivision development adjacent to lake posing access and crowding issues just to name a few. The GLA Board of Trustees saw a compelling presentation on this topic and has interest in establishing a fund or earmarking funds should the need for legal representation become necessary. The recommendation received was having \$20K "ready" for such purposes. The GLA Board of Trustees has not made a final decision on the nature of such a fund.

(Continued on page 8)



Join the GLA Facebook Group!

Join the Gravel Lake Association Facebook group! It is an excellent way for us to connect with our fellow lakere. Important lake-related information is posted there frequently, including weed treatment dates, when the newsletter is available, event info, lost-and-found info, announcements, recommendations, and surveys where you can voice your opinion. People also post pictures from around the lake, even in the winter!

GLA Membership Dues (continued from page 7)

Finally, as a membership we discussed the possibility of a boat wash at our public access. As many understand, the public access (DNR site) is our single largest source of Aquatic Invasive Species (AIS...e.g. eurasian watermilfoil, starry stonewort, zebra mussels, etc.). Refer to our feature article on this topic (on page 4) for more details. No decisions have been made on a boat wash, but it's another example of a funding need for Gravel Lake.

Many of the aforementioned topics are new to Gravel Lake. They represent a proactive mindset rather than a reactive one. They also present a bigger picture, longer term vision for Gravel Lake. We can boast high water quality, strong home values, and a truly unique community with excellent social activities. That said, the GLA must be open-minded, open-eyed, and at least somewhat vigilant in protecting this very special place. With all modesty, I dare to believe that the unprompted dues increase vote is an indication we're moving in the right direction.

Craig DeSimone
GLA President

Help Stop Aquatic Hitchhikers! Get Involved!

Question: What is the best way to prevent the spread of invasive species?

Answer:

1. Clean any visible mud, plants, or fish off of your boat by rinsing it off with clean water.
2. Drain all water holding compartments (including live wells, bait wells, and bilge areas).
3. Dry boats and trailers before entering another body of water.

The Clean Boats, Clean Water Initiative is a way to educate people, state-wide, about how invasive species spread. Just like any other lake, ours is vulnerable to these invasive species. (Anyone else remember how fun it was when Eurasian Watermilfoil had us stopping our boats to clean the prop a quarter of the way around the lake?)

Spread the word about the Clean Boats, Clean Water Initiative!



**STOP AQUATIC
HITCHHIKERS!**

Prevent the transport of nuisance species.
Clean all recreational equipment.
www.ProtectYourWaters.net

ADAMS

EST.  1860
HARDWARE

LAWTON, MI
269 624-3531

Summer Events Thanks

Fourth of July Events

It seems like ages ago now, but the GLA would like to thank all of the wonderful volunteers who made the Fourth of July events fantastic! Thank you so much to both the organizers and the additional volunteers for your efforts, without which, the events could not take place. These are the events that draw people to Gravel Lake and help keep our little community thriving.

Fun Run- Eric Herchenroether and family

Kids Games- Joshua Richards

Boat Parade- Lauren Roman

Paddle Boat Regatta- Kerry Moore and Michael Micheli

Poker Run

Our biggest fundraiser, and most popular event, is the Poker Run! It takes a TON of work to organize and put on the event. We are all so grateful for the work of our volunteers who selflessly offer their services so that we can enjoy this super fun (though the next day isn't always so fun...) event at Gravel Lake. And a huge thanks to our sponsors for their generous donations, several of which have donated year after year!

Event organizers- Janice Pinkos, Alyssa Pinkos, Suzanne Reed, Tricia Barker, and Darla Kelliher

Day-of Volunteers- Sue Eberly, Maureen Maffei, Laura & Lydia Mencl, Denise Shroeder, May Moore, Kevin LaLone, Brittany Pinkos, and Linda, Ken & Kristy Vitkauskas

Dock hosts- Hermanson/Sadowski families, Todd Harrison, Kerry Moore/Ryan Stewart, Eric and Michelle Nitz, Pat Beebe and family, Christine Seput, Sue and Scott Forcash, and Linda and Ken Vitkauskas

Poker Run Sponsors- Lake and Country Real Estate, Dock Bros., SangriLa Farms, Trademark Irrigation, Revele Properties, Rampart Engineering, Copper Ridge Inn & Market, The Rock, Mencl Builders, St. Julian, WakeSide Marine, Scott's Pig Roast, Action Watersports, and Michigan Herbals/Faustinos



Origins of Huff's Landing

On March 2, 1839, Orsamus Bushnell of New York purchased 75.70 acres from the United States. It was described as, "The Northwest Fractional Quarter of Section 31, Town 4 South, Range 13 West". Today we refer to these 75.70 acres as Huff's Landing and Sandy Beach. Mr. Bushnell subsequently sold the 75+ acres to Horatio & Mary Lawrence in 1851. Then in 1857 the Lawrence's sold to Alvin & Fanny Taylor. There was a \$200 mortgage on the property at that time. From the mid-1800's to the late 1800's the parcel was bought and sold, or lost and foreclosed upon several times. Sometime in the late 1800's it appears the 75.70 acres began to be divided and cottages were constructed.

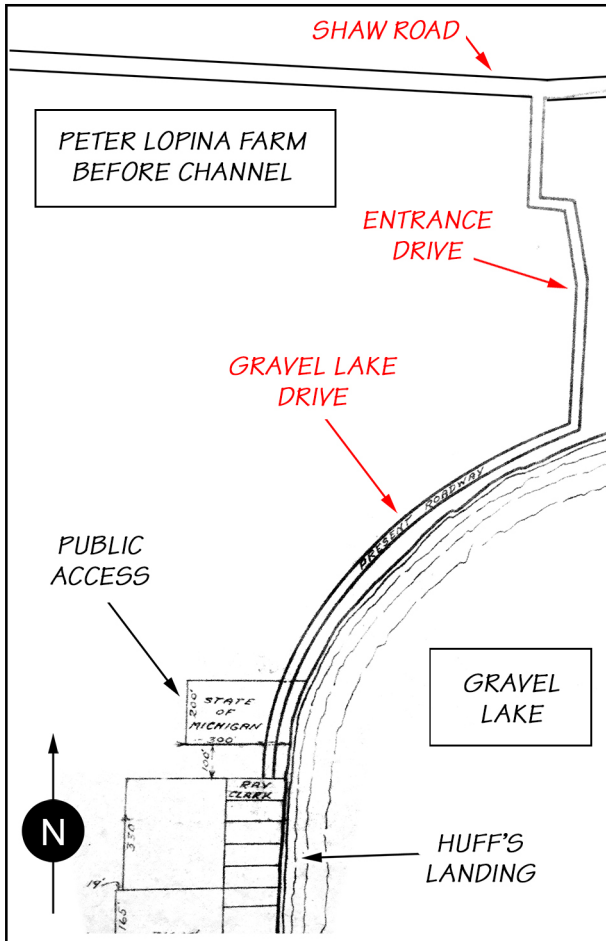

On April 30th of 1915 Otis & Irene Huff purchased a portion of the area known as Oak Bluff, later to be renamed "Huff's Landing". Mr. Huff was a local attorney in Marcellus. He was also owner and editor of the Marcellus newspaper. His daughter Elsie and her husband Bernard Kirk built their retirement home on a parcel in 1976, replacing an earlier cottage. Mr. Otis Huff eventually sold a north parcel to his friend Dr. Adams of Marcellus. Dr. Adams then sold or donated a portion of the parcel now known as the DNR Public Access. Today one of the other parcels purchased in the early 1900s by Nelson Christenson of Mishawaka, Indiana remains in the family and is now owned by Paul & Mary (Bukacek) Howell. They recently replaced the original cottage built in the very early 1900's. (Their beautiful home is a light blue color now. It used to be red on top and stone on the bottom).

Huff's Landing was eventually divided into lots with a private drive/deeded easement intersecting individual lots. Today there are 13 home parcels on Huff's Landing.

The remainder of the original 75.70 acres purchased by Orsamus Bushnell from the United States became Sandy Beach. The Sandy Beach channel was dug in 1952-1953, and developed by realtor LaVern Rice, creating many additional parcels for cottages. A January 10, 1941 survey shows all of Sandy Beach as the Peter Lapina farm with no channel or Gravel Lake Drive, and a road along the shoreline to Huff's Landing.

John Deren, Huff's Landing

Meet a Gravel Laker



If there is one thing Gravel Lake is known for, it would be its community. As far as associations go (not to toot our own [boat]horn - too much), I would say ours is top notch. Whether you have been on this lake your entire life, or just one summer, I think you can feel the love. One family who caught the lovebug for Gravel Lake is the Urban family. Josh and his wife are now the proud owners of a lake home on Sandy Beach.

Rockport, Illinois natives Joshua and Jennifer Urban weren't complete strangers to the lake when they bought their home in 2019, just a few days before Labor Day. Jennifer's mother and stepfather, Sharon and Jim Braglia, are just 300 feet away on the channel as well. Joshua owns his own audio video business and Jennifer works in sales for a medical office. They always knew they wanted a summer home for their family. To get the family outdoors and away from their screens, they searched from Wisconsin, down to Indiana, but found themselves back

at Gravel Lake. "We wanted a lake house where there was a strong community, events for the kids, and for us; the feeling of everyone getting together and enjoying each other's company. That's probably the main reason we chose Gravel Lake. Everyone we have met so far has been amazing," say the Urbans.

Along with their children, Taylor (12), Aiden (10), and Arianna (5), Joshua and Jennifer have fallen in love with their 1950s-built lake house. Located at the very end of the channel, full of character, a four seasons room, and a picket fence for their dog Zuma, theirs has the perfect summer cottage feel. "When we're here, it really feels like we're on vacation," Joshua explains. There is so much they have already taken advantage of on their new property. The previous owners (the Paresi family) left a paddle boat, and oldest daughter Taylor spent an entire day cleaning it and restoring it to its former glory. The kids, especially youngest daughter Arianna, enjoy their frog pond in the yard.

The Urban family's lake house journey may have only begun, but they look forward to many summers and even winter visits ahead. They hope to spend time on the lake paddle boarding, fishing, tubing, kayaking, and more. Their son Aiden even participated in the paddle board division of the regatta and was the youngest participant. With so much to look forward to, Josh says "my favorite part is sitting on the dock at night watching the stars. [It] clears my head and makes me appreciate life."

Emily Garrett

Poison Ivy

Fall has arrived! The cooler weather means the end of this year's lake season, but as we know, that doesn't mean the yard work stops. 'Tis the season for mowing, raking, weeding, and bonfires! One nasty little bugger to watch out for during the fall season is poison ivy. Whether you've heard of it, or suffered from it, you know what a pain it can be! But how much do you really know about our three-leafed foe?

First of all, we must identify the ivy leaves. "Leaves of three, let them be" is an easy way to remember. Poison ivy is green with one leaf in the center and two on the sides, and the leaves can be smooth or have toothy edges. Poison ivy lies low on the forest floor, it may crawl up on low bushes or shrubs, and it grows along walking paths. I have seen poison ivy on the path at the end of Huff's Landing, so be on the lookout!

Why does poison ivy itch so bad and cause a rash? There is an oil on the leaves, called urushiol oil, that causes your body to have an allergic response. The allergens in the oil create inflammation in the form of a red bumpy rash on your skin that can start showing up 24 hours or so after the contact with the plant. Even indirect contact with the plant, like petting your dog who has rolled around in ivy, can spread the rash to you. The rash may spread quickly on your body and become very itchy and uncomfortable. Inhaling the smoke of burning poison ivy can also be dangerous. Be careful what you are throwing in your fall bonfires! The smoke can cause itchy eyes, and it can even affect your lungs. If you think this has happened to you, seek medical attention quickly.

What do I do when I see poison ivy? The best advice is to steer clear and cover up. Cover your feet, legs, arms, hands, and anything that may be in contact with the leaves.

(Continued on page 14)



Poison Ivy (continued from page 13)

What if I do come in contact with poison ivy? Because the poison ivy rash might not show up for up to 72 hours after contact, you may not be able to take action right away. But if you are sure that your skin has been in contact with poison ivy, it is key to immediately wash the area with lukewarm, soapy water. Alcohol wipes will do if soap and water is not an option. Be sure to give anything that touched the poison ivy a wash-down as well. Rakes, hoses, garden tools, boots, gloves, animals, etc. must be washed to remove the oils. And don't worry, your pet may transfer the oils to you, but his/her fur is enough to keep the oils from creating a rash on your furry friend.

It's so itchy; What can I do to relieve the discomfort? Inflammatory symptoms, like itching, can be treated with steroids. Hydrocortisone is an easy-to-find, over-the-counter steroid that comes in familiar brand names like Cortizone 10 or Tecnu. These are topical agents that can be applied right to the rash to relieve those pesky symptoms.

So enjoy the beautiful fall foliage that Michigan offers, but be on the lookout for this mean, green leaf this fall!



We specialize in

Painted Furniture Ornaments
Signs Personalized Pillows

Follow us on 

630-561-9082



Treasurer's Report

Beginning Balance as of 1/1/19

\$37,859.01

Deposits

Membership Dues - PayPal 1	\$33.68
Membership Dues - 24	\$1,050.00
Fish Stocking Donation from Non-Lake Resident	\$500.00
Membership Dues - 5	\$310.00
Membership Dues - 2	\$85.00
Apparel Sales	\$30.00
Membership Dues 16	\$560.00
Membership Dues 18	\$1,005.00
Gravel Laker Advertising	\$110.00
Membership Dues - PayPal 16	\$830.20
Membership Dues 21	\$905.00
Membership Dues 24	\$1,230.00
Membership Dues - PayPal 5	\$246.08
Membership Dues - PayPal 5	\$221.81
Advertsing	\$170.00
Membership Dues 21	\$890.00
Membership Dues - PayPal 8	\$312.84
Picnic - Sale of food	\$44.00
Magnets	\$55.00
Poker Run Sponsorship - Mencil	\$150.00
Split the Pot - Winner portion donated back	\$311.00
Membership Dues 32	\$1,310.00
Apparel Sales - Meeting	\$2,358.00
Membership Dues 8	\$400.00
Advertsing - Summer Gravel Laker	\$450.00
Membership Dues - PayPal 4	\$159.00
Apparel Sales - 4th of July	\$2,117.00
Apparel Sales - Gararage Sale	\$1,275.00
Membership Dues -1	\$35.00
Donation from Garage Sale	\$20.00
Membership Dues - PayPal 6	\$308.90
Membership Dues -13	\$480.00
Advertising - Gravel Laker	\$120.00
Apparel Sales	\$73.00
Poker Run Sponsorship	\$1,175.00



Treasurer's Report (continued from page 15)

Poker Run	\$6,440.00
Poker Run Donation from Winner - Tom Logan	\$50.00
Apparel Sales	\$217.00
Split the Pot - Winner portion donated back	\$177.00
Poker Run Sponsors	\$300.00
Membership Dues - 2 (1 from 2018)	\$105.00
Sticker Sales	\$12.00
Petty Cash Redeposited	\$120.00
Total Deposits	\$26,751.51

Expenses

JMC Studios, Inc. - Website Hosting	\$60.00
Laggis Fish Farm - Balance for Perch	\$1,045.00
Cannopeum - Picnic Rentals	\$764.97
Michigan Lake & Streams Membership	\$250.00
Riparian Memberships	\$1,848.00
USPS - Stamps for Invoices	\$198.00
Staples - Printing for Invoices	\$280.32
Suzanne Reed - Welcome Baskets	\$22.78
Print Mill - Gravel Laker	\$604.61
Tee-Shirt Printing Plus	\$1,752.98
US Postal Service - PO Box Rental	\$60.00
Petty Cash	\$120.00
Flory Excavating - Picnic	\$105.00
The Canopeum - Picnic	\$106.00
Craig DeSimone - Printing & Picnic Expense	\$34.82
Thornton Insurance Agency - Surety Bond	\$100.00
Kerry Moore - 4th of July Activity Trophies	\$219.10
Shelley Richards - 4th of July Kids Games	\$200.00
Eric Herchenrother - 4th of July Fun Run	\$100.00
T-Shirt Printing Plus	\$1,226.69
Suzanne Reed - Welcome Baskets	\$52.66
Darla Kelliher - Poker Run After Party Stipend	\$750.00
Poker Run - 7 Check to Dock Hosts \$150 Each	\$1,050.00
Suzanne Reed - Picnic Supplies	\$42.31
Suzanne Reed - Welcome Baskets	\$20.54
Suzanne Reed - Signs for Poker Run	\$26.50
Tee-Shirt Printing Plus - Poker Run Tee Shirts	\$626.46

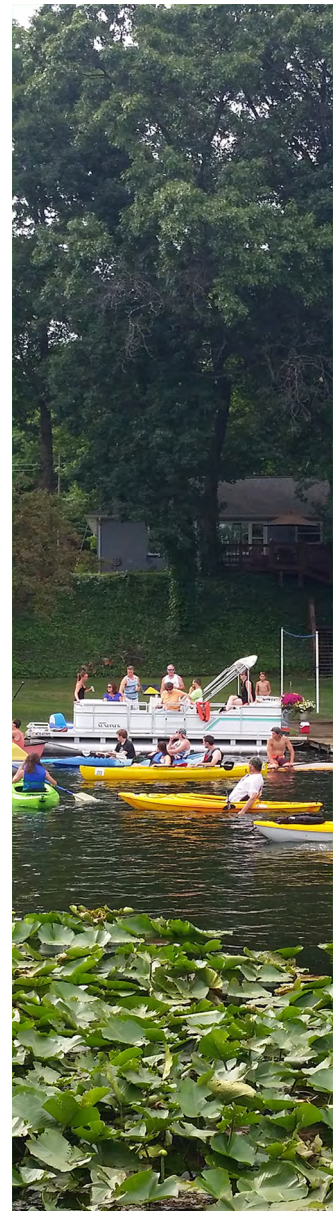

Treasurer's Report (continued from page 16)

Expenses

Janice Pinkos - Poker Run Expense, Cards, Printing	\$240.22
Darla Kelliher - Poker Run Supplies	\$40.00
Janice Pinkos - Treats Annual Meeting	\$27.87
Auto Owners - Insurance	\$1,179.00
Apollo Marine - Buoy Maintenance	\$626.98

Total Expenses **\$13,780.81**

Checkbook Balance as of 9/15/19 **\$50,829.71**

Other Assets:

Total Funds **\$50,829.71**



WAKE SIDE MARINE



WakeSideMarine.com • Call or Text: 574-264-2874
NAUTIQUE • SOUTH BAY • BARLETTA • YAMAHA • MERCURY

Membership Paid Listings

Thank you to the families mentioned on the following pages for their support of the Gravel Lake Association. Continued support through dues payment allows the association and its volunteers the financial backing to provide its residents with a quality lake community we're all proud to be a part of. The families listed with an asterisk gave additional donations to fish stocking or the overall fund - Thank you! Don't worry if you have not paid your 2019 dues yet, there is still time. You can pay online at our website, www.gravellake.org, or use the form in the back of this newsletter.

Thanks again for your support!

PAY DUES ONLINE AT



Membership Paid Listings

Beach	Last Name	First Name
Chamberlin	Bainbridge	Jane & Mark *
Chamberlin	Barker	Tim & Lynn
Chamberlin	Beebe	Patrick
Chamberlin	Beilby	Danene Metz & Joe
Chamberlin	Bounardj	Ellen
Chamberlin	Carlos	Paul & Vicki
Chamberlin	Crowley	Jeanette Cox & Terri
Chamberlin	DeSimone	Craig & Missy
Chamberlin	Enright	Frank & Pam
Chamberlin	Fletcher/Patnode	Diane & Ken *
Chamberlin	Garvey	Mike & Jen *
Chamberlin	Jensen	Shirley
Chamberlin	Jeske	Doris & David
Chamberlin	Levan	Victor & Pam
Chamberlin	Melton	Bruce & Penny
Chamberlin	Poyser	Steve & Sheila
Chamberlin	Reeder	Bev & Harley
Chamberlin	Rockwell	Jim & Arlene
Chamberlin	Rogers	Patricia Covert, Priscilla & Mark *
Chamberlin	Seehausen	Dean
Chamberlin	Vennergrund	Jim & Nancy *
Chamberlin	Wunderlich	Frank & Virginia
Chamberlin	Zwartz	Tim & Elizabeth
Dugan's	Keene	Larry & Connie
Dugan's	Lalone	Kevin & Tammy *
Dugan's	Laski	Harry & Vicki
Dugan's	Manning Martin Cottage	Jan Lapine & Nancy
Dugan's	Murphy	Sarah Spiller
Dugan's	Oxley	Chris & Stacey *
Dugan's	Oxley	Ed & Phyllis
Dugan's	Puttkammer	Thomas & Lauren *
Dugan's	Vogt	Doreen & James
Gebhard	Ayala	Anna & Gilbert *
Gebhard	Beck	Charlotte *
Gebhard	Cleary	William & Mary *
Gebhard	DeSimone	Carlie & Carol A
Gebhard	Dyrek	Vince & Nancy *
Gebhard	Eggers	Herb & Lory

* Extra donation or fish stocking



Membership Paid Listings (continued from page 20)

Gebhard	Enright	Gerry
Gebhard	Fazzini	Mark & Teec *
Gebhard	Fortney	Mark & Geri
Gebhard	Frick	Ronald & Mari
Gebhard	Gordon	Mark & Perri
Gebhard	Jennings	Alice *
Gebhard	Kurtyak	Sheri *
Gebhard	Locicero	Mark & Brenda
Gebhard	Logan	Tom & Irene *
Gebhard	May	Joseph & Stephanie
Gebhard	Menci	Craig & LaShel *
Gebhard	Menci	Gary & Laura *
Gebhard	Murphy	Doug Dale Denny & Judy
Gebhard	Raab	Ron & Susan
Gebhard	Rinaldi	Phil & Mary *
Gebhard	Schuld	Therese & Dan
Gebhard	Stade	Jon & Heather
Gebhard	Svrlinga	John & Debbie *
Gebhard	Walter	Pat *
Huff's Landing	Brucks	Trisha Barker & Greg *
Huff's Landing	Carollo	Steve & Monica *
Huff's Landing	Deren	Jean Bahnsen & John
Huff's Landing	Gilhooly	Frank & Kathy
Huff's Landing	Harrell	Tom & Pat
Huff's Landing	Hermanson	James *
Huff's Landing	Howell	Paul & Mary *
Huff's Landing	McDevitt	Dan & Marilyn *
Huff's Landing	Roesch	Lenore *
Huff's Landing	Rusthoven	Robin & Tim *
Idle Ease	Betts	Matt & Kristi *
Idle Ease	Biss	Sherman & Billie *
Idle Ease	Boender	Nancy *
Idle Ease	Cunningham	Joe & Kathy Creswell *
Idle Ease	Devereaux	Doug Lemons & Jackie
Idle Ease	Dmitrovich	MaryBeth Gaspar & Steve *
Idle Ease	Eberly	Ken & Susan
Idle Ease	Garrison	Rich & Derith *
Idle Ease	Heuring	Mike & Marge *
Idle Ease	Hobbs	Roger & Connie
Idle Ease	Hunter	Mark & Susan

* Extra donation or fish stocking



Membership Paid Listings (continued from page 21)

Idle Ease	Jabaay	Jim & Patti *
Idle Ease	Jacques	Beverly & Jim *
Idle Ease	The Jacques Family	
Idle Ease	Kapercev	Victor & Darlene *
Idle Ease	Kehlenbeck	Mark & Jane *
Idle Ease	Mateyack	Don & Audrey *
Idle Ease	Nedvar	Jane
Idle Ease	Pinkos	Steve & Janice *
Idle Ease	Prichard	Jim & Shirley
Idle Ease	Samolczyk	Jesse & Jeannette
Idle Ease	Spohn	Mike & Mark
Idle Ease	Wells	Ronald & Karen
Idle Ease	Zwartz	Tom & Kathy *
Lewis	Airgood	Annette & Ralph *
Lewis	Cechota	Richard & Rosie *
Lewis	Fernandez	Tom & Karen *
Lewis	Fernandez	William
Lewis	Forward	Richard
Lewis	Goeprich/Lord	Josephine/Rose
Lewis	Greenwood	Wayne & Marilyn
Lewis	Hochsprung	Ken & Marysue *
Lewis	Jandacek	Ed & Diane *
Lewis	O'Neill	Stephen & Roberta *
Lewis	Roussel	Wayne & Mary
Lewis	Van Schoyck	Chip & Lisa
Sandy	Anderson	Ed & Lois
Sandy	Anderson	Harold & Karen
Sandy	Barber	Ray & Diane
Sandy	Bjork	Sue *
Sandy	Braglia	James & Sharon *
Sandy	Brockner	Terry & Judy
Sandy	Brown	David & Mary
Sandy	Bukacek	Sharon Rudnick & Martin *
Sandy	Clifford	Mike & Joanne *
Sandy	Custer	Mark & MaryBeth *
Sandy	Davis	Kevin & Mary
Sandy	Drew	Kathy & Mark
Sandy	Edwards	Sheila
Sandy	Fewell	Chris & Amy *
Sandy	Forcash	Susan *
Sandy	Grembowicz	Larry & Terry *

* Extra donation or fish stocking



Membership Paid Listings (continued from page 22)

Sandy	Harrison	Todd *
Sandy	Hart	Chuck & Mary *
Sandy	Herchenroether	Eric & Rachael
Sandy	Hornblower	Margot *
Sandy	Humble	Warren & Nancy
Sandy	James	Holly & Todd
Sandy	Jones	Terry & Fran *
Sandy	Jurusik	Mike & Tracy *
Sandy	Kelly	Erwin & Betty
Sandy	Lalone	Keith & Michelle
Sandy	Lawrence	Paul & Cathy *
Sandy	Leisten	Gary & Vickie *
Sandy	Lowe	Dasher & Maria *
Sandy	Mahany	Mark & Tina *
Sandy	Mateyack	John & Mary Ann
Sandy	McGreal	Jim & Elizabeth
Sandy	Micheli	Jen & Michael
Sandy	Mills	Steven & Rebecca *
Sandy	Morkunas	Lynn Gilliland & Dennis
Sandy	Motter	Paul & Ann *
Sandy	Nicola	Rick & Monica *
Sandy	Orr	John & Sue *
Sandy	Parisi	John & Diane *
Sandy	Phelan	Rich & Jane *
Sandy	Placzek	Jessica Velich & John *
Sandy	Reed	Ray & Suzanne
Sandy	Rhoades	David & Melissa
Sandy	Schlueter	Bob & Linda *
Sandy	Schroeder	Carol *
Sandy	Schroeder	Jim & Patricia *
Sandy	Schroeder	Kenneth
Sandy	Skoropad	George & Florence
Sandy	Smith	Don & Jeanne
Sandy	Stefo	Andrew & Kathryn *
Sandy	Stevens-Miller	Gayle *
Sandy	Storm	Robert & Jean *
Sandy	Sugden	Lezley & Joe
Sandy	Swalec	Amy & Jeff *
Sandy	Tokarsky	Matt & Alexis
Sandy	Toso	Christopher & Linda
Sandy	VanMeter	Fran

* Extra donation or fish stocking



Membership Paid Listings (continued from page 23)

Sandy	Vick	Bob & Sherri *
Sandy	Welcome	Art & Mary
Sandy	Williams	Mark & Leslie *
Sandy	Witteveen	Mark & Crystal
Streeter	Bartock	David & Susan *
Streeter	Bogner	Jack *
Streeter	Bridgham	Richard & Debra *
Streeter	DeRosa	Rick & Donna *
Streeter	Dorsey	Deborah
Streeter	Fallon	Trish & Tim *
Streeter	Garrett	Greg & Marianne
Streeter	Gordon	Frank & Jane *
Streeter	Huber	Tom & Kare *
Streeter	Jilek	James *
Streeter	Mattox	Tom & Virginia *
Streeter	Mayer	Mark & Elizabeth
Streeter	Mc BrideKaren	Triplett & Ann
Streeter	Meskimen	Bob & Nancy
Streeter	Paulik	Mark & April *
Streeter	Richards	Bart & Shelley
Streeter	Rimes	Moon *
Streeter	Rucinski	Peter & Beverly *
Streeter	Small	John & Joann *
Streeter	Stamos	Nicole & George *
Streeter	Stemler	Wynne
Streeter	Vitkauskas	Ken & Linda *
Willow	Bontrager	Peggy Lockwood & Terry
Willow	Brooks	Lamar
Willow	Caskey	Judy Weis & John *
Willow	Chipp	Rich & Kelly
Willow	Cox	Ray *
Willow	Engle	Dale & MaryAnn
Willow	Felus	Nick & Sara
Willow	Graham	Greg & Donna *
Willow	Heneghan	Marty & Kathy
Willow	Kelliher	Tom & Darla *
Willow	Kopetski	Stephen & Suzanne
Willow	Kussurelis	Tom & Heidi *
Willow	Malinauskas	Mary *
Willow	Mascarello	Mike *
Willow	Moore	Richard & May Britt

* Extra donation or fish stocking



Membership Paid Listings (continued from page 24)

Willow	Osborn	Mark & Melanie
Willow	Rau	Jim & Donna *
Willow	Rau	Kyle *
Willow	Roeder	Carole & Al
Willow	Schroeder	Dean & Denise
Willow	Vankerk	Grant & Linda *
Willow	Wilson	Darrell & Grace
Winkler	Balon	Sandra
Winkler	Beebe	Cassie
Winkler	Bergenham	Jim & Jill
Winkler	Bibbee	David & Sue *
Winkler	Calacci	John & Mari Jo
Winkler	Cerney	Jim & Jane *
Winkler	Dorkin	Danny & Annette
Winkler	Faustino	John & Patti *
Winkler	Hartmann	Joseph & Kelly *
Winkler	Hess	Randy & Sherri *
Winkler	Johnson	Ken & Laurie
Winkler	Komorowski	Lori
Winkler	Krzyszkowski	Bernie Krueger & Marion *
Winkler	LaForge	Ann *
Winkler	LaMonte	John & Mary Ann *
Winkler	Metz	William & Pat
Winkler	Murray	Michael & Mary
Winkler	Murray	Pat & Ann *
Winkler	Nitz	Eric & Michelle *
Winkler	Quick	Raymond & Judy
Winkler	Ries	Sherri & Dave
Winkler	Robison	Daniel & Anne
Winkler	Sadowski	Mike & Sue *
Winkler	Siemer	George & Pam
Winkler	Swindeman	John & Maralyn
Winkler	Swindeman	Monte & Sue
Winkler	Wojtanek	Ken & Sue *
Winkler	Yager	Martin

* Extra donation or fish stocking



*"F" is for firefly that shines in the dark
and lights up the lake
with its tiny white spark*



*I am thankful for all the wonderful people
I have met here over the past years and have
helped to realize their dream.*

More than 33 GRAVEL LAKE CLOSINGS!

**Hire Experience, Enthusiasm & Excellence
for your next Lake Buying or Selling Experience**

Newsletter Staff

Jamie Paramski, Editor
jparamski@gmail.com

Jim McGreal, Design
jim@jmcstudios.com

Spencer McGreal, Production/Graphics
spencer@jmcstudios.com

Bob Vick - Ads
djbob365@gmail.com

Chip vanSchoyck, Printer

Melissa DeSimone, Contributing writer

Tricia Barker, Contributing writer

Emily Garrett, Contributing writer

Place An Ad In The Gravel Laker!

To place an ad
in our next issue
contact Bob Vick

Text or Email
269.744.2136

djbob365@gmail.com



Sources

DNR - Invasive Species - Boating and Fishing Laws: https://www.michigan.gov/invasives/0,5664,7-324-68071_91899---,00.html

CD3 Cleaning Station: <https://www.cd3station.com/>

Michigan Clean Boats & Clean Waters Initiative: <https://micbcw.org/>



La Cantina
SINCE 1936 ®

RISTORANTE ITALIANO & PIZZERIA

Open Tuesday thru Sunday at 5pm

UNTIL END OF DECEMBER - CLOSED ALL OF JANUARY

Gravel Lake Tuesday Night Club
Thank you for making it a special night.

139 W Michigan Ave, Paw Paw, MI

www.lacantinapawpaw.com



Rent, Buy or Trade

World Class Service Center



Financing Available

***Hundreds of Boats,
Pontoons, & PWCs In Stock***



***World Class Service From
Your Family Owned Dealer!***

Leaders *RPM*

 Recreation  Powersports  Marine 

866-572-1051 LeadersRPM.com
8500 W. Main St., Kalamazoo, MI

Gravel Lake Association

Membership Form: January 2020 - December 2020

Fill out and mail to:

Gravel Lake Association, P.O. Box 531, Lawton, MI 49065

You can also pay dues online at gravellake.org.

Please print clearly.

Member name(s): _____

Beach: _____ Lake Phone: _____

Gravel Lake Address: _____ Lawton, MI 49065

Home Address: _____

City: _____ State: _____ Zip: _____

Home Phone: _____

E-mail address: _____

Please print clearly. Mail Check or Money Order payable to Gravel Lake Association

Membership dues for 2020 \$50.00

I would like to receive 4 free issues of the Riparian magazine for 2020.

Yes No (circle one)

Address where your Riparian should be sent.

Home Lake (circle one)

Fish Stocking Donation \$10.00 \$15.00 \$25.00 or Other _____

Total Enclosed _____



Board of Trustees Contact List

OFFICERS

President	Craig DeSimone - cucad4@hotmail.com
Vice President	Suzanne Reed
Secretary	Melissa DeSimone
Treasurer	Janice Pinkos - fampinkos@aol.com

OTHER CONTRIBUTORS

Editor, Gravel Laker	Jamie Paramski - jparamski@gmail.com
Newsletter Advertising / Printing	Bob Vick/Chip Van Schoyck
Fundraising	Carlie Stogis- (chair)
Internet Operations	Jim McGreal - jim@jmcstudios.com
ALS Control	Ken Hochsprung

TRUSTEES

Chamberlin Beach	Craig DeSimone Arlene Rockwell
Dugan's Landing	Kevin LaLone
Gebhard Beach	Phil Rinaldi
Huff's Landing	Dan McDevitt
Idle Ease Beach	Janice Pinkos Tom Zwartz
Lewis Beach	Ken Hochsprung
Sandy Beach	Suzanne Reed Jennifer Micheli Chris Toso
Streeter Beach	Kristy & Linda Vitkauskas
Willow Beach	Carole Roeder
Winkler Beach	Dave Brown Ann LaForge

Gravel Lake Association

P.O. Box 531
Lawton, MI 49065
www.gravellake.org



Apply Address Here